

**SUNFLEX UK** ✨



Sliding doors



# ULTRA-SLIM ALUMINIUM SLIDING DOORS

An innovative range of sliding doors that combine virtually unobstructed views, effortless usability and finishing touches you will not find on other sliding doors.

For more than 20 years SUNFLEX UK has manufactured specialist aluminium door systems and our range of highly engineered sliding doors offer the perfect solution for larger openings in extensions, renovations or new builds; maximising the amount of glass and breaking down the boundaries between inside and out.

Our SVG range of sliding doors all incorporate versatility, aesthetic appeal, reliability and independently accredited security, whatever the size or configuration of door you choose.

## Made in Britain

Every SUNFLEX UK sliding door is handmade by our expert fabricators in our own factory in the UK, providing complete peace of mind on quality, workmanship and attention to detail.



## Unobstructed views

Our sliding doors can create virtually unobstructed views thanks to large glass panels and minimal frames. With slender frame depths these doors look slim from all angles not just face on.



## Security

The SVG sliding doors carry a range of independent security accreditations including the prestigious BSI Kitemark™, Secured by Design™ award as well as exceeding the requirements of PAS 24:2016 testing to comply with Building Regulations.



## Flush floor finish

Our sliding doors are supplied with weather-shield cover plates, that not only enhance the performance of the doors, they also cover unused elements of the track that can provide a stylish flush finish between inside and out.



## Attention to detail

The flush stacking finish is a real must-have and sets the SUNFLEX UK sliding doors apart from the rest. The door panels are cleverly designed to stack neatly in-line with each other when the doors are fully opened, creating a clean and contemporary appearance.

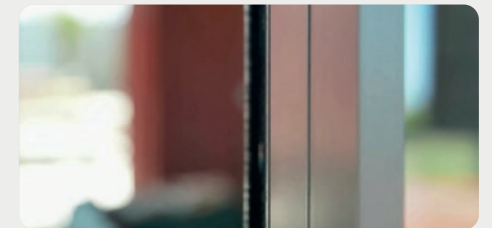

## A choice of handles

Choose from stainless steel or colour-matched feature handles in either round or rectangular profile for the ultimate in style or choose a slender D-handle powder coated to match the colour of the doors.

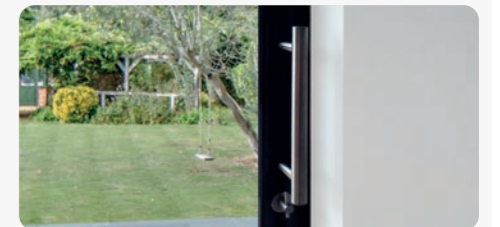

# SLIDING DOORS SVG20

NEW ultra-slim 20mm aluminium sliding doors

Designed with incredibly narrow 20mm sightlines, the new SUNFLEX UK SVG20 is capable of creating an almost seamless wall of glass, ideal for breaking down the boundaries between inside and out, whilst filling the rooms full of light.

Thanks to its advanced design the SVG20 features slender frame depths without the need of external reinforcing, allowing the doors to appear slim whichever angle they are viewed from and provide the ultimate in contemporary appearance.

The SVG20 can be custom made in an almost unlimited range of configurations to fit openings from just 1.8m up to 24m wide. The advanced design and attention to detail extend to the operation of the doors as well, with the doors providing effortless operation even at the maximum panel width of 3m wide.



## Key features

- Incredibly narrow 20mm intermediate frames between glass provide maximise light and provide a stylish appearance.
- Versatile panel widths from 800mm to 3 metres wide and up to 2.8m high (panel width dependent).
- Quality assured to prestigious BSI Kitemark™ standards.
- Advanced engineered running gear provides effortless operation.
- PAS 24: 2016 and Secured by Design™ security accreditations.
- Choose from stainless steel or standard colour feature handles or colour matched D-shaped or recessed handles.
- Flush stacking allowing each panel to stack neatly behind the neighbouring frame.
- Available in more than 200 RAL colours textured finishes ensuring the doors perfectly complement your home.
- Impressive thermal efficiency with U-values from just 1.2W/m<sup>2</sup>K.
- Independently weather tested to severe weather rating – Class 7a (300Pa) water tightness, Class 3 (600Pa) air permeability, Wind class AE (2,400Pa) wind loading.
- Excellent security with five-point mushroom headed cam bolts and claw lock.
- Available in lift and slide option for the lead door.
- A wide range of configuration options including moveable corner posts and extended tracks that mean the doors can be tailored to your exact requirements.



## SLIDING DOORS SVG30

Hugely popular 30mm aluminium sliding door

With its slender 30mm sightlines, large glass panels and advanced performance, the SVG30 has quickly become the best-selling SUNFLEX UK sliding door system.

Whichever angle you view the doors from the SVG30 offers slim sightlines, maximising the views out whilst connecting your home and garden. The versatile design allows for large panes of glass that help draw light into the home, whilst maintaining the ease of use, advanced security and superior quality that all SUNFLEX UK products are renowned for.

With individual panel widths of up to 3m wide and available in a range of configurations from a single panel door sliding on an extended track into a pocket all the way up to an overall system width of 24m, each set of doors is manufactured to your exact specifications including the choice of tracks, handle options and more than 200 colours and finishes.



### Key features

- Incredibly slim frame of just 30mm with no requirements for external reinforcing profile, reducing the sightlines when viewed from any angle.
- PAS 24: 2016 and Secured by Design accredited.
- Quality assured to prestigious BSI Kitemark™ standards.
- Impressive thermal efficiency with U-values from just 1.2W/m<sup>2</sup>K.
- Versatile panel widths from 800mm to 3 metres wide and up to 2.8m high (depending on panel width).
- Independently weather tested to severe weather rating – Class 7a (300Pa) water tightness, Class 3 (600Pa) air permeability, Wind class AE (2,400Pa) wind loading.
- Flush stacking allowing each panel to stack completely behind the next.
- Excellent security with five-point mushroom headed cam bolts and claw lock.
- Advanced engineering provides a stunning appearance and effortlessly smooth running.
- A wide range of configuration options including moveable corner posts and extended tracks that mean the doors can be tailored to your exact requirements.
- Available in more than 200 RAL colours textured finishes ensuring the doors perfectly complement your home.
- Choose from stainless steel or standard colour feature handles or colour matched D-shaped or recessed handles.
- Available in lift and slide option for the lead door.

# SLIDING DOORS POCKET SLIDER

Add a real wow-factor with doors that slide into a pocket

Pocket sliding doors are the latest innovation in sliding door technology. Whereas a sliding door within a standard configuration would see panels slide behind a fixed frame that sits within the opening, with a pocket sliding door you are able to slide all of the panels on an extended track on the inside of the wall.

By doing this it is possible to create a completely unobstructed aperture that seamlessly connects your home and garden when the doors are fully opened, yet with large glass panels and slim aluminium frames that are perfect for letting in light when closed.

Our pocket sliding doors are available utilising the panels of either of our sliding door systems, the SVG20 with ultra-slim 20mm sightlines or the SVG30 with incredibly narrow 30mm intermediate frames. With a completely flush track achievable and super-smooth operation as standard our exclusive pocket sliding doors are perfectly suited for new-build or extension projects and create a real design feature and 'wow' factor for any home.



## Key features

- Available utilising the panels of either our SVG20 or SVG30 systems.
- Versatile panel widths from 800mm to 3 metres wide and up to 2.8m high depending on width.
- Quality assured to prestigious BSI Kitemark™ standards.
- Independently weather tested to severe weather rating Class 7a (300Pa) water tightness, Class 3 (600Pa) air permeability, Wind class AE (2,400Pa) wind loading.
- Creates a real 'wow' factor for projects, seamlessly connecting the house and garden when doors are opened.
- PAS 24: 2016 and Secured by Design accredited.
- Excellent security with five-point mushroom headed cam bolts and claw lock.
- Impressive thermal efficiency with U-values from just 1.2W/m<sup>2</sup>K.
- Advanced engineering provides a stunning appearance and effortlessly smooth running.
- A wide range of configuration options available from a single panel sliding door up to 6 panels (3-left, 3-right) with 18m overall width.
- Available in more than 200 RAL colours textured finishes ensuring the doors perfectly complement your home.
- Choose from stainless steel or standard colour feature handles or colour matched D-shaped or recessed handles.





## SLIDING DOORS OPEN CORNERS

Create floating corners with our sliding doors

Created with an integrated corner post, our floating corner sliding doors can be slid back to create a completely open corner that allows your home to connect with your garden to create the appearance of a room that never ends.

Over the last 10 years SUNFLEX UK has perfected the design of open corner sliding doors and they can be design utilising either the SVG20 or SVG30 ultra-slim systems to create stunning panoramic views and add a real wow-factor to any project.

Our open corner sliding doors feature the same effortless usability and attention to detail as our standard configuration doors, ensuring those who choose our doors don't just get a system that looks incredible, but also one that performs perfectly time after time, year after year.



### Key features

- Choose from the SVG20 (20mm sightlines) or SVG30 (30mm sightlines) for your open corner design.
- Integrated moveable corner post with full-height locking bar creates stunning appearance when open whilst securing the doors when closed.
- PAS 24: 2016 and Secured by Design™ security accreditations.
- Excellent security with five-point mushroom headed cam bolts and claw lock.
- Impressive thermal efficiency with U-values from just 1.2W/m²K.
- Flush stacking allowing each panel to stack neatly behind the neighbouring frame.
- A range of configuration options either side of the corner post to meet the exact requirements of your project.
- Available in more than 200 RAL colours textured finishes ensuring the doors perfectly complement your home.
- Quality assured to prestigious BSI Kitemark™ standards.
- Advanced engineered running gear provides effortless operation.
- Can be designed to incorporate pocket sliding door functionality or Art Deco inspired heritage design.
- Choose from stainless steel or standard colour feature handles or colour matched D-shaped or recessed handles.

# SLIDING DOORS HERITAGE

Art Deco inspired aluminium glass sliding doors

Our exclusive range of Art Deco-inspired heritage sliding doors with narrow mid-rails combines period style with contemporary performance and is a stylish on-trend solution for those renovating traditional properties or seeking to add character to new-build extensions or homes.

Utilising our advanced SVG30 sliding door technology, our heritage sliding doors are ideal creating larger openings and can be designed with up to eight panels for larger openings as well as incorporating open corners or panels that slide into a recess in the wall.

Each door is made to order from thermally broken aluminium frames to meet the efficiency requirements of Building Regulations, whilst also benefitting from advanced security, an almost infinite range of configurations including pocket and open corner designs.



## Key features

- Utilising our SVG30 sliding doors with ultra-slim 30mm frames and horizontal glazing bars to give the much sought-after Art Deco style.
- Impressive thermal efficiency with U-values from just 1.2 W/m<sup>2</sup>k.
- Quality assured to prestigious BSI Kitemark™ standards.
- PAS 24: 2016 and Secured by Design™ security accreditations.
- Excellent security with five-point mushroom headed cam bolts and claw lock.
- Flush stacking allowing each panel to stack neatly behind the neighbouring frame.
- Choose from stainless steel or powder coated feature handles or colour matched D handles.
- Available in more than 200 RAL colours textured finishes ensuring the doors perfectly complement your home.
- Advanced engineered running gear provides effortless operation.
- Can be designed to incorporate pocket sliding door functionality or open corner.



# HANDLE OPTIONS



Round stainless steel feature handle



Round powder coated feature handle



Rectangular stainless steel feature handle



Rectangular powder coated feature handle

The SVG20 and SVG30 are available with stylish round or rectangular feature handles (in stainless steel or standard colour finishes), or with a D-shaped handle colour matched to the frame of the doors. It is also possible to fit the doors with a colour coded recessed handle.



D-shaped handle (colour coded)



Recessed handle (colour coded)

# THERMAL AND WEATHER PERFORMANCE

SVG20 and SVG30

U-value of glass (W/m <sup>2</sup> K)	Overall system U-value (W/m <sup>2</sup> K), from:
1.0 (double glazed)	1.5
0.7 (double glazed)	1.3
0.5 (double glazed)	1.2

Weather test	Performance
Air permeability BS EN 12207	Class 3 600 Pascals
Water tightness BS EN 1027	Class 7A 300 Pascals
Wind load BS EN 12211	Class AE 2,400 Pascals

# TECHNICAL DETAILS

Sight line detail

SVG20

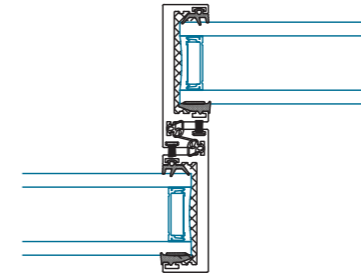

SVG30

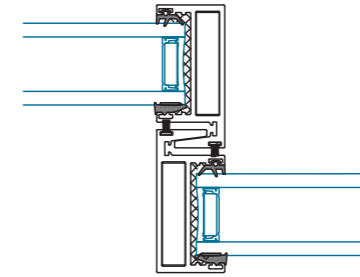

Sight line detail

Twin track with sill

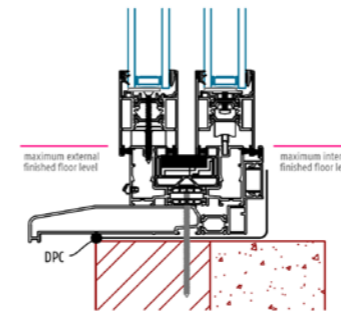

Triple track with sill

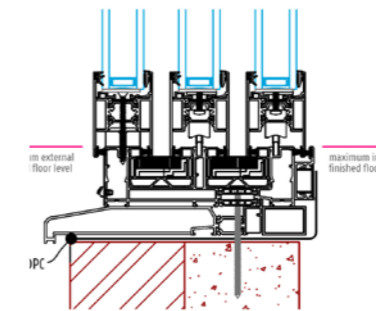

Twin track no sill

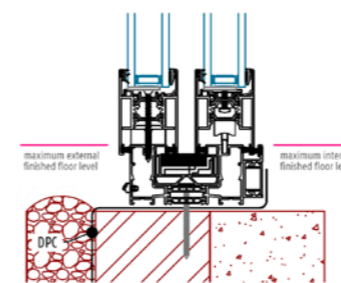

Triple track no sill

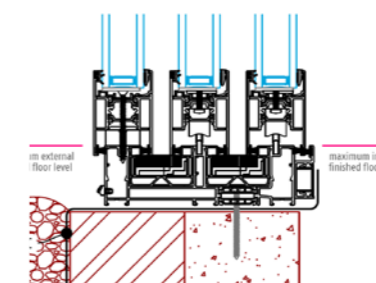

RAL colours

Alternatively you can select from more than 200 RAL colours, including the option to have the doors a different colour on the internal and external face of the door, perfect if you are trying to match interior décor and exterior finishes.

# COLOURS

Choose from one of three standard RAL finishes or opt for a custom coloured frame to perfectly complement your project. The three popular standard colours and finishes are:

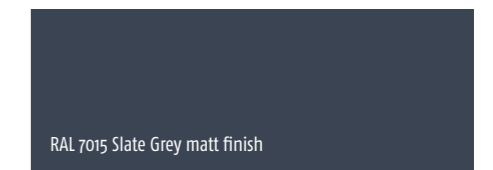
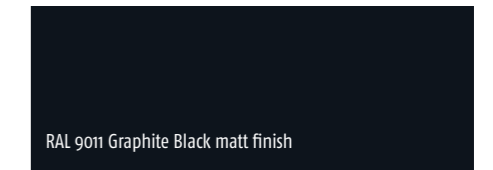

Our most popular non-standard colours include

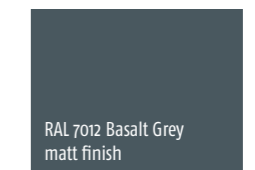
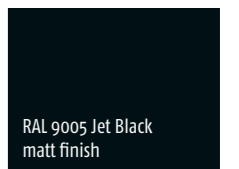
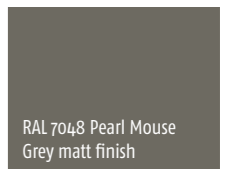
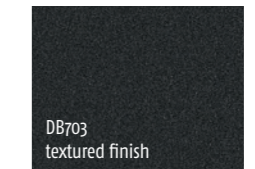

Please note: Whilst every effort has been made to display the available colours accurately, the examples shown in this brochure should be used as an indication only. If you would like an aluminium colour sample of your required finish please ask your distributor or email us at [info@sunflexuk.co.uk](mailto:info@sunflexuk.co.uk) or call 01603 424434.





Bifold doors

Sliding doors

Heritage doors

Aluminium windows

Glass roofs

Front doors

Internal glass partitions

Commercial doors

**SUNFLEX UK** 

[sunflexUK.co.uk](http://sunflexUK.co.uk)